

## Description

<sup>EN</sup> Luminaire housing from extruded aluminium profile with 38mm wide light exit; for trimless installation in plasterboard ceilings; special edge design with perforations for better adhesion of filler; designed for continuous lighting systems; suitable for ceiling thickness of 8–20 mm; surface raw; luminaire profile with pre-assembled converter unit can be pre-mounted; light inset can be installed without tools; HPO (High Performance Opal) cover for uniform illumination; or micro prismatic PMMA diffuser incl. diffuser film for homogeneous illumination and reduced luminance; or with specially computed, asymmetrical lens for homogeneous vertical lighting intensity; energy-efficient LEDs with very good colour rendering; binning initial  $\leq 3$  MacAdam; available in the light colours 3000 K and 4000 K; CRI  $\geq 80$ ; min. 90 % of the luminous flux after 50 000 hours; degree of protection IP20; PC I; photobiological safety according to IEC 62471 risk group 0; optionally non-dimmable or DALI-2 control

<sup>ES</sup> Perfil de aluminio extrusionado con salida de luz de 38 mm de anchura; apropiada para montaje sin marco en techos de yeso; formación especial de borde con orificios para una mejor adherencia de la masilla; diseñado para la creación de sistemas continuos; apropiada para grosores de techo entre 8-20 mm; superficie sin tratar; perfil de luminaria con convertidor premontado está premontable; elemento de luz para montaje sin herramientas; difusor opal de alta calidad que proporciona una iluminación uniforme; o cubierta microprismática de PMMA con lámina difusora para la reducción de iluminación y un alumbrado homogéneo; o con lente especialmente calculada, asimétrica para intensidades de iluminación verticales homogéneas; LEDS de alta eficiencia que proporcionan una alta reproducción cromática; binning inicial  $\leq 3$  MacAdam; disponible en 3000 K y 4000 K; CRI  $\geq 80$ ; mín. 90 % de flujo luminoso después de 50.000 horas de vida útil; protección IP20; CP I; seguridad fotobiológica según IEC 62471 grupo de riesgo 0; opcional no atenuable o control con DALI-2

## BASO 40 system

recessed trimless

## Quickinfo

3000 K, 4000 K  
CRI  $\geq 80$   
L90 @ 50 000h  
up to 3030 lm/m  
non DIM, DALI-2  
opal, microprismatic,  
asymmetric lens (wallwasher)

## Types

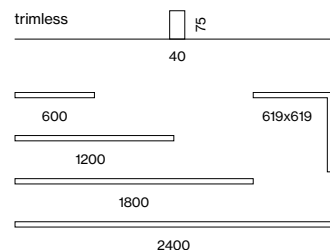

## Colour



## Light distributions



direct asym.

### Order options

|                           |    |
|---------------------------|----|
| <b>COLOUR TEMPERATURE</b> | ☐☐ |
| 3000K                     | 5  |
| 4000K                     | 6  |

|                |     |
|----------------|-----|
| <b>CONTROL</b> | ⬆⬇⬆ |
| non DIM        | 1   |
| DALI-2         | 3   |

|                        |   |
|------------------------|---|
| <b>MATERIAL COLOUR</b> | ● |
| aluminium raw          |   |

|                              |   |
|------------------------------|---|
| <b>LIGHT OPTIC COVER</b>     | ☐ |
| opal high performance        | H |
| microprismatic               | Z |
| asymmetric lens (wallwasher) |   |

### Options on request

|                               |  |
|-------------------------------|--|
| <b>COLOUR RENDERING INDEX</b> |  |
| CRI ≥ 90                      |  |

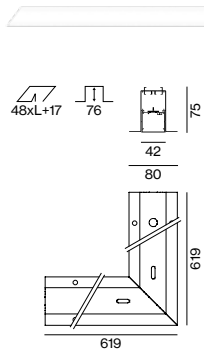

### BASO 40 trimless



#### OPAL HIGH PERFORMANCE / MICROPRISMATIC

| SYSTEM POWER                     | L (mm)   | ORDER CODE             |
|----------------------------------|----------|------------------------|
| 14W                              | 600      | 0 4 5 - 0 6 2 2 ☐☐ 0 ☐ |
| 27W                              | 1200     | 0 4 5 - 0 6 2 4 ☐☐ 0 ☐ |
| 41W                              | 1800     | 0 4 5 - 0 6 2 6 ☐☐ 0 ☐ |
| 55W                              | 2400     | 0 4 5 - 0 6 2 8 ☐☐ 0 ☐ |
| 69W                              | 3000     | 0 4 5 - 0 6 2 9 ☐☐ 0 ☐ |
| 27W corner                       | 619x619  | 0 4 5 - 0 6 6 1 ☐☐ 0 ☐ |
| 27W flexible inset (every 150mm) | 750-1200 | 0 4 5 - 0 6 2 F ☐☐ 0 ☐ |

order luminaire + mounting accessories separately

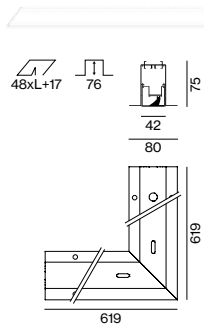

### BASO 40 trimless



#### WALLWASHER

| SYSTEM POWER                     | L (mm)   | ORDER CODE             |
|----------------------------------|----------|------------------------|
| 14W                              | 600      | 0 4 5 - 0 6 2 2 ☐☐ 0 A |
| 27W                              | 1200     | 0 4 5 - 0 6 2 4 ☐☐ 0 A |
| 41W                              | 1800     | 0 4 5 - 0 6 2 6 ☐☐ 0 A |
| 54W                              | 2400     | 0 4 5 - 0 6 2 8 ☐☐ 0 A |
| 69W                              | 3000     | 0 4 5 - 0 6 2 9 ☐☐ 0 A |
| 27W corner outer beam            | 619x619  | 0 4 5 - 0 6 6 1 ☐☐ 0 A |
| 27W corner inner beam            | 619x619  | 0 4 5 - 0 6 6 2 ☐☐ 0 A |
| 27W flexible inset (every 150mm) | 750-1200 | 0 4 5 - 0 6 2 F ☐☐ 0 A |

order luminaire + mounting accessories separately

| COVER                 | COLOUR TEMP. | SYSTEM POWER | DELIVERED LUMENS | EFFICACY |
|-----------------------|--------------|--------------|------------------|----------|
| opal high performance | 3000K        | 23W/m        | 2210lm/m         | 98lm/W   |
|                       | 4000K        |              | 2350lm/m         | 104lm/W  |
| microprismatic        | 3000K        | 23W/m        | 2030lm/m         | 90lm/W   |
|                       | 4000K        |              | 2160lm/m         | 96lm/W   |
| asymmetric            | 3000K        | 23W/m        | 2870lm/m         | 127lm/W  |
|                       | 4000K        |              | 3030lm/m         | 135lm/W  |

### Accessories

#### CHANNEL + BLIND COVER

| TYPE                 | L (mm)  | ORDER CODE              |
|----------------------|---------|-------------------------|
| linear               | 1200    | 0 4 5 - 0 6 0 4 0 0 7 B |
| linear               | 2400    | 0 4 5 - 0 6 0 8 0 0 7 B |
| corner connector 90° | 619x619 | 0 4 5 - 0 6 4 1 0 0 7 B |
| custom cut           | -       | E 8 4 1 3 0 . . . . 7 B |

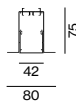

#### END CAPS

| TYPE            | ORDER CODE            |
|-----------------|-----------------------|
| end caps (pair) | 0 4 5 - 0 6 3 0 0 1 0 |

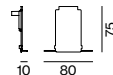

#### LINEAR CONNECTOR

| TYPE                         | ORDER CODE                  |
|------------------------------|-----------------------------|
| linear connector (1 piece)   | 0 4 5 - 0 4 3 1 1 1 0       |
| linear connector (10 pieces) | 0 4 5 - 0 4 3 1 1 1 0 . 1 0 |

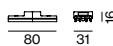

#### THROUGH WIRE

| TYPE   | ORDER CODE        |
|--|-------------------|
| 3 × 1.5 mm <sup>2</sup> (non DIM, 10 pieces) | 0 0 4 - 9 0 0 0 3 |
| 5 × 1.5 mm <sup>2</sup> (DALI-2, 10 pieces)  | 0 0 4 - 9 0 0 0 5 |

### LIGHT DISTRIBUTION

