

# SASSO 60 sensor sense trim soft acoustic ceiling

048-2693121 048-2696397



Project / Type

Notes

Count / Date



Round sensor inset; SENSE (brightness, presence, temperature, humidity, air quality and noise level sensor); surface lacquered in jet black; 360° rotatable; installation without tools with mounting kit; round installation housing; with trim traffic white; for installation in soft acoustic ceilings; suitable for ceiling thickness of 25-40 mm; degree of protection from below IP40 (from above IP20); PC2; 220-240 V; DALI-2 control;

## Product drawing



### General

Ceiling | Recessed

rotation 360°

jet black | RAL 9005

Mounting set traffic white

front IP40 | back IP20

### Electrical

DALI-2 SENSE sensor | 1 DALI Addr.

brightness, presence, temperature, sound pressure, air quality, humidity

PC2 | 220-240 V

### Physical

with trim for acoustic ceiling

diameter 80 mm | height 29 mm

0.19 kg

### Cutout

diameter 74 mm

min. ceiling thickness 25 mm | max. ceiling thickness 40 mm

recessed depth 60 mm

## Installation instructions



# SASSO 60 sensor sense trim soft acoustic ceiling

048-2693121 048-2696397



Project / Type

Notes

Count / Date

## Components

### MOUNTING SET with trim for soft acoustic ceilings

COLOUR	Ø (MM)	ARTICLE NUMBER(S)
traffic white	80	048-2696397

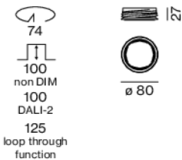

## Mounting accessories

### MOUNTING TOOL

TYPE	COLOUR	L-W-H (MM)	ARTICLE NUMBER(S)
for soft acoustic ceilings	traffic black	77-77-35	048-2695918

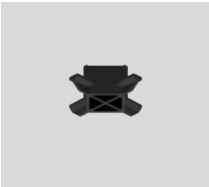

## Electrical accessories

### REPLACEMENT ACCUPACK

TYPE	ARTICLE NUMBER(S)
3h battery life	048-2693910

