

# TARO 32 downlight

MOVE IT 10 round

030-6740433S



Project / Type \_\_\_\_\_

Notes \_\_\_\_\_

Count / Date \_\_\_\_\_



Cylindrical spotlight in aluminium; surface lacquered in brushed brass; light inset can be installed and moved without tools by means of clip mount; power supplied via MOVE IT system track profile; hot plug protection; passive cooling of the LEDs through improved heat sink geometry; light colour 2700 K; binning initial MacAdam  $\leq 2$  SDCM; CRI  $\geq 90$ ; min. 80% of luminous flux after 50000 operating hours; energy efficient LEDs with high CRI; good glare control through recessed light point level; precise radiation characteristic with 18° beam; no multiple shadows; optical attachment available as accessory; accessories are listed separately; degree of protection IP20; PC3; 48 V; DALI-2 control; flicker-free visual comfort through analogue current control (minimum value 1%); light source replaceable by an authorized professional;

## Light distribution

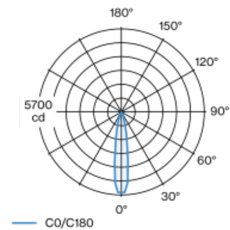

spot 18°			
h (m)	E0° (lx)	ø (m)	
1	5560	0.32	
2	1390	0.63	
3	620	0.95	
4	350	1.27	
5	220	1.58	

## Product drawing

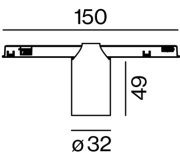

## General

Ceiling / Wall , Track \_\_\_\_\_

brushed brass \_\_\_\_\_

IP20 \_\_\_\_\_

734 lm \_\_\_\_\_

optical inset 85 lm/W<sup>1</sup> \_\_\_\_\_

## LED

2700 K \_\_\_\_\_

CRI  $\geq 90$  \_\_\_\_\_

L80 / 50000 h \_\_\_\_\_

initial MacAdam  $\leq 2$  SDCM \_\_\_\_\_

R<sub>g</sub>: 99 , R<sub>f</sub>: 91 , R<sub>(f1-15)</sub>: 89 \_\_\_\_\_

MR 0.53 \_\_\_\_\_

MDER 0.48 \_\_\_\_\_

## Optical

spot \_\_\_\_\_

beam angle 18° \_\_\_\_\_

PstLM  $\leq 1.0$  <sup>2</sup> \_\_\_\_\_

SVM  $\leq 0.4$  <sup>2</sup> \_\_\_\_\_

## Electrical

DALI-2 \_\_\_\_\_

48 V \_\_\_\_\_

fixture 9.6 W \_\_\_\_\_

optical inset 8.7 W \_\_\_\_\_

PC3 \_\_\_\_\_

1 DALI Addr. \_\_\_\_\_

## Physical

diameter 32 mm \_\_\_\_\_

height 60 mm \_\_\_\_\_

0.06 kg \_\_\_\_\_

<sup>1</sup> incl. consideration of optical losses  
<sup>2</sup> Value of containing product at full load (undimmed)

## Installation instructions

