

TARO 32 downlight

MOVE IT 10 round
030-6740533M



Project / Type _____

Notes _____

Count / Date _____



Cylindrical spotlight in aluminium; surface lacquered in brushed brass; light inset can be installed and moved without tools by means of clip mount; power supplied via MOVE IT system track profile; hot plug protection; passive cooling of the LEDs through improved heat sink geometry; light colour 3000 K; binning initial MacAdam ≤ 2 SDCM; CRI ≥ 90 ; min. 80% of luminous flux after 50000 operating hours; energy efficient LEDs with high CRI; good glare control through recessed light point level; precise radiation characteristic with 24° beam; no multiple shadows; optical attachment available as accessory; accessories are listed separately; degree of protection IP20; PC3; DALI-2 control; flicker-free visual comfort through analogue current control (minimum value 1%); light source replaceable by an authorized professional;



General

Ceiling / Wall , Track _____

brushed brass _____

IP20 _____

811 lm _____

LED

3000 K _____

CRI ≥ 90 _____

L80 / 50000 h _____

initial MacAdam ≤ 2 SDCM _____

R_g: 100 , R_f: 91 , R_{f(1-5)}: 88 _____

MR 0.59 _____

MDER 0.53 _____

Optical

Medium _____

beam angle 24° _____

Electrical

DALI-2 _____

9.6 W _____

PC3 _____

84 lm/W _____

1 DALI Addr. _____

Physical

diameter 32 mm _____

height 60 mm _____

Light distribution

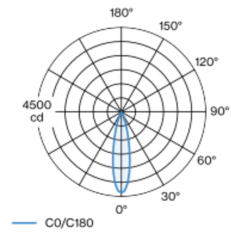

medium 24°

h (m)	EO° (lx)	ø (m)
1	4310	0.42
2	1080	0.83
3	480	1.25
4	270	1.67
5	170	2.09

Product drawing

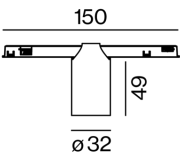

Installation instructions

