

# TARO 32 downlight

MOVE IT 10 round  
030-6740533S



Project / Type \_\_\_\_\_

Notes \_\_\_\_\_

Count / Date \_\_\_\_\_



### General

Ceiling / Wall , Track \_\_\_\_\_

brushed brass \_\_\_\_\_

IP20 \_\_\_\_\_

778 lm \_\_\_\_\_

optical inset 90 lm/W<sup>1</sup> \_\_\_\_\_

### LED

3000 K \_\_\_\_\_

CRI ≥ 90 \_\_\_\_\_

L80 / 50000 h \_\_\_\_\_

initial MacAdam ≤ 2 SDCM \_\_\_\_\_

R<sub>g</sub>: 100 , R<sub>f</sub>: 91 , R<sub>f(1-15)</sub>: 88 \_\_\_\_\_

MR 0.59 \_\_\_\_\_

MDER 0.53 \_\_\_\_\_

### Optical

spot \_\_\_\_\_

beam angle 18° \_\_\_\_\_

PstLM ≤ 1.0 <sup>2</sup> \_\_\_\_\_

SVM ≤ 0.4 <sup>2</sup> \_\_\_\_\_

### Electrical

DALI-2 \_\_\_\_\_

48 V \_\_\_\_\_

fixture 9.6 W \_\_\_\_\_

optical inset 8.7 W \_\_\_\_\_

PC3 \_\_\_\_\_

1 DALI Addr. \_\_\_\_\_

### Physical

diameter 32 mm \_\_\_\_\_

height 60 mm \_\_\_\_\_

0.09 kg \_\_\_\_\_

### Light distribution

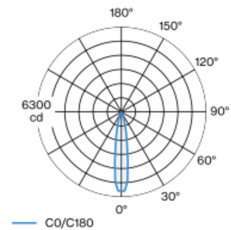

spot 18°			
h (m)	E0° (lx)	ø (m)	
1	5890	0.32	
2	1470	0.63	
3	650	0.95	
4	370	1.27	
5	240	1.58	

### Product drawing

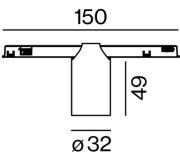

<sup>1</sup> incl. consideration of optical losses  
<sup>2</sup> Value of containing product at full load (undimmed)

### Installation instructions



# TARO 32 downlight

MOVE IT 10 round  
030-6740533S



Project / Type

Notes

Count / Date

## Maintenance Factors

Operating Time [h]	10 000	20 000	30 000	40 000	50 000
LLMF	0.96	0.92	0.89	0.85	0.82
LSF	1	1	1	1	1

MF

MF

LMF<sup>a</sup>

LMF × RSMF × LLMF × LSF

Maintenance Factor

Luminaire Maintenance Factor

RSMF<sup>a</sup>

LLMF

LSF

Room Surface Maintenance Factor

Lamp Lumens Maintenance Factor

Lamp Survival Factor

<sup>a</sup> According to "CIE 97, Maintenance of indoor electric lighting systems", 2005, ISBN 3-900-734-34-8. The values must be determined by the planner.

## Optical accessories

### HONEYCOMB LOUVER

COLOUR	Ø (MM)	ARTICLE NUMBER(S)
jet black	30	007-1965168



## Optical accessories

### OVAL LENS

Ø (MM)	ARTICLE NUMBER(S)
30	007-1965860



### SOFT LENS

Ø (MM)	ARTICLE NUMBER(S)
30	007-1965960



### WALLWASHER LENS

Ø (MM)	ARTICLE NUMBER(S)
30	007-1965760

