

TARO 32 downlight

MOVE IT 10 round
030-6740535S



Project / Type _____

Notes _____

Count / Date _____



Cylindrical spotlight in aluminium; surface anodised gun metal; light inset can be installed and moved without tools by means of clip mount; power supplied via MOVE IT system track profile; hot plug protection; passive cooling of the LEDs through improved heat sink geometry; light colour 3000 K; binning initial MacAdam ≤ 2 SDCM; CRI ≥ 90 ; min. 80% of luminous flux after 50000 operating hours; energy efficient LEDs with high CRI; good glare control through recessed light point level; precise radiation characteristic with 18° beam; no multiple shadows; optical attachment available as accessory; accessories are listed separately; degree of protection IP20; PC3; DALI-2 control; flicker-free visual comfort through analogue current control (minimum value 1%); light source replaceable by an authorized professional;



General

Ceiling / Wall , Track _____

gun metal _____

IP20 _____

778 lm _____

LED

3000 K _____

CRI ≥ 90 _____

L80 / 50000 h _____

initial MacAdam ≤ 2 SDCM _____

R_g: 100 , R_f: 91 , R_{f(1-15)}: 88 _____

MR 0.59 _____

MDER 0.53 _____

Optical

Spot _____

beam angle 18° _____

Electrical

DALI-2 _____

9.6 W _____

PC3 _____

81 lm/W _____

1 DALI Addr. _____

Physical

diameter 32 mm _____

height 60 mm _____

Light distribution



spot 18°			
h (m)	E0° (lx)	ø (m)	
1	5890	0.32	
2	1470	0.63	
3	650	0.95	
4	370	1.27	
5	240	1.58	

Product drawing

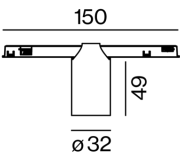

Installation instructions

