

TARO 32 downlight

MOVE IT 10 round
030-6740539F



Project / Type _____

Notes _____

Count / Date _____



Cylindrical spotlight in aluminium; surface anodised rose gold; light inset can be installed and moved without tools by means of clip mount; power supplied via MOVE IT system track profile; hot plug protection; passive cooling of the LEDs through improved heat sink geometry; light colour 3000 K; binning initial MacAdam ≤ 2 SDCM; CRI ≥ 90 ; min. 80% of luminous flux after 50000 operating hours; energy efficient LEDs with high CRI; good glare control through recessed light point level; precise radiation characteristic with 34° beam; no multiple shadows; optical attachment available as accessory; accessories are listed separately; degree of protection IP20; PC3; DALI-2 control; flicker-free visual comfort through analogue current control (minimum value 1%); light source replaceable by an authorized professional;



General

Ceiling / Wall , Track _____

rose gold _____

IP20 _____

774 lm _____

LED

3000 K _____

CRI ≥ 90 _____

L80 / 50000 h _____

initial MacAdam ≤ 2 SDCM _____

R_g: 100 , R_f: 91 , R_{f(1-15)}: 88 _____

MR 0.59 _____

MDER 0.53 _____

Optical

Flood _____

beam angle 34° _____

Electrical

DALI-2 _____

9.6 W _____

PC3 _____

81 lm/W _____

1 DALI Addr. _____

Physical

diameter 32 mm _____

height 60 mm _____

Light distribution



flood 34°

h (m)	E0° (lx)	ø (m)
1	2520	0.61
2	630	1.21
3	280	1.82
4	160	2.42
5	100	3.03

Product drawing

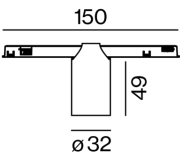

Installation instructions



TARO 32 downlight

MOVE IT 10 round
030-6740539F



Project / Type

Notes

Count / Date

Maintenance Factors

Operating Time [h]	10 000	20 000	30 000	40 000	50 000
LLMF	0.96	0.92	0.89	0.85	0.82
LSF	1	1	1	1	1

MF

LMF × RSMF × LLMF × LSF

MF

Maintenance Factor

LMF^a

Luminaire Maintenance Factor

RSMF^a

Room Surface Maintenance Factor

LLMF

Lamp Lumens Maintenance Factor

LSF

Lamp Survival Faktor

^a According to "CIE 97, Maintenance of indoor electric lighting systems", 2005, ISBN 3-900-734-34-8. The values must be determined by the planner.

Optical accessories

HONEYCOMB LOUVER

COLOUR	Ø (MM)	ARTICLE NUMBER(S)
jet black	30	007-1965168

