

# TARO 32 downlight

MOVE IT 10 round  
030-6740538F



Project / Type

Notes

Count / Date



Cylindrical spotlight in aluminium; surface jet black powder coated; light inset can be installed and moved without tools by means of clip mount; power supplied via MOVE IT system track profile; hot plug protection; passive cooling of the LEDs through improved heat sink geometry; light colour 3000 K; binning initial MacAdam  $\leq 2$  SDCM; CRI  $\geq 90$ ; min. 80% of luminous flux after 50000 operating hours; energy efficient LEDs with high CRI; good glare control through recessed light point level; precise radiation characteristic with 34° beam; no multiple shadows; optical attachment available as accessory; accessories are listed separately; degree of protection IP20; PC3; DALI-2 control; flicker-free visual comfort through analogue current control (minimum value 1%); light source replaceable by an authorized professional;



### General

Ceiling / Wall , Track

jet black , RAL9005 <sup>1</sup>

IP20

774 lm

### LED

3000 K

CRI  $\geq 90$

L80 / 50000 h

initial MacAdam  $\leq 2$  SDCM

R<sub>g</sub>: 100 , R<sub>f</sub>: 91 , R<sub>f(1-5)</sub>: 88

MR 0.59

MDER 0.53

### Optical

Flood

beam angle 34°

### Electrical

DALI-2

9.6 W

PC3

81 lm/W

1 DALI Addr.

### Physical

diameter 32 mm

height 60 mm

### Light distribution



flood 34°			
h (m)	E0° (lx)	ø (m)	
1	2520	0.61	
2	630	1.21	
3	280	1.82	
4	160	2.42	
5	100	3.03	

### Product drawing

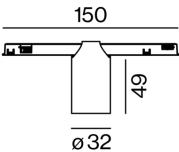

<sup>1</sup> RAL code

### Installation instructions

