

TARO 32 downlight

MOVE IT 10 round
030-6740634F



Project / Type _____

Notes _____

Count / Date _____



General

Ceiling / Wall , Track _____

chrome _____

IP20 _____

820 lm _____

optical inset 94 lm/W¹ _____

LED

4000 K _____

CRI ≥ 90 _____

L80 / 50000 h _____

initial MacAdam ≤ 2 SDCM _____

R_g: 97 , R_f: 90 , R_{t(1-15)}: 89 _____

MR 0.81 _____

MDER 0.74 _____

Optical

flood _____

beam angle 34° _____

PstLM ≤ 1.0 ² _____

SVM ≤ 0.4 ² _____

Electrical

DALI-2 _____

48 V _____

fixture 9.6 W _____

optical inset 8.7 W _____

PC3 _____

1 DALI Addr. _____

Physical

diameter 32 mm _____

height 60 mm _____

0.17 kg _____

Light distribution

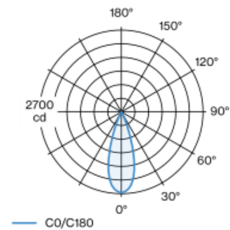

flood 34°		
h (m)	E0° (lx)	ø (m)
1	2670	0.61
2	670	1.21
3	300	1.82
4	170	2.42
5	110	3.03

Product drawing

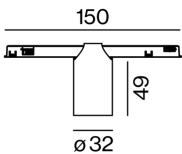

¹ incl. consideration of optical losses
² Value of containing product at full load (undimmed)

Installation instructions



TARO 32 downlight

MOVE IT 10 round
030-6740634F



Project / Type

Notes

Count / Date

Maintenance Factors

Operating Time [h]	10 000	20 000	30 000	40 000	50 000
LLMF	0.96	0.92	0.89	0.85	0.82
LSF	1	1	1	1	1

MF

MF

LMF^a

LMF × RSMF × LLMF × LSF

Maintenance Factor

Luminaire Maintenance Factor

RSMF^a

LLMF

LSF

Room Surface Maintenance Factor

Lamp Lumens Maintenance Factor

Lamp Survival Factor

^a According to "CIE 97, Maintenance of indoor electric lighting systems", 2005, ISBN 3-900-734-34-8. The values must be determined by the planner.

Optical accessories

HONEYCOMB LOUVER

COLOUR	Ø (MM)	ARTICLE NUMBER(S)
jet black	30	007-1965168



Optical accessories

OVAL LENS

Ø (MM)	ARTICLE NUMBER(S)
30	007-1965860



SOFT LENS

Ø (MM)	ARTICLE NUMBER(S)
30	007-1965960



WALLWASHER LENS

Ø (MM)	ARTICLE NUMBER(S)
30	007-1965760

