

# TARO 32 downlight

MOVE IT 10 round

030-6740634S



Project / Type \_\_\_\_\_

Notes \_\_\_\_\_

Count / Date \_\_\_\_\_



### General

Ceiling / Wall , Track \_\_\_\_\_

chrome \_\_\_\_\_

IP20 \_\_\_\_\_

825 lm \_\_\_\_\_

optical inset 95 lm/W<sup>1</sup> \_\_\_\_\_

### LED

4000 K \_\_\_\_\_

CRI ≥ 90 \_\_\_\_\_

L80 / 50000 h \_\_\_\_\_

initial MacAdam ≤ 2 SDCM \_\_\_\_\_

R<sub>g</sub>: 97 , R<sub>f</sub>: 90 , R<sub>t(1-15)</sub>: 89 \_\_\_\_\_

MR 0.81 \_\_\_\_\_

MDER 0.74 \_\_\_\_\_

### Optical

spot \_\_\_\_\_

beam angle 18° \_\_\_\_\_

PstLM ≤ 1.0 <sup>2</sup> \_\_\_\_\_

SVM ≤ 0.4 <sup>2</sup> \_\_\_\_\_

### Electrical

DALI-2 \_\_\_\_\_

48 V \_\_\_\_\_

fixture 9.6 W \_\_\_\_\_

optical inset 8.7 W \_\_\_\_\_

PC3 \_\_\_\_\_

1 DALI Addr. \_\_\_\_\_

### Physical

diameter 32 mm \_\_\_\_\_

height 60 mm \_\_\_\_\_

### Light distribution

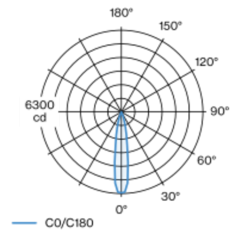

spot 18°			
h (m)	EO° (lx)	ø (m)	
1	6250	0.32	
2	1560	0.63	
3	690	0.95	
4	390	1.27	
5	250	1.58	

### Product drawing

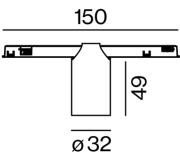

<sup>1</sup> incl. consideration of optical losses  
<sup>2</sup> Value of containing product at full load (undimmed)

### Installation instructions

