

# TARO 32 downlight

MOVE IT 10 round  
030-6740436M



Project / Type

Notes

Count / Date



Cylindrical spotlight in aluminium; surface lacquered in brushed aluminium; light inset can be installed and moved without tools by means of clip mount; power supplied via MOVE IT system track profile; hot plug protection; passive cooling of the LEDs through improved heat sink geometry; light colour 2700 K; binning initial MacAdam  $\leq 2$  SDCM; CRI  $\geq 90$ ; min. 80% of luminous flux after 50000 operating hours; energy efficient LEDs with high CRI; good glare control through recessed light point level; precise radiation characteristic with 24° beam; no multiple shadows; optical attachment available as accessory; accessories are listed separately; degree of protection IP20; PC3; DALI-2 control; flicker-free visual comfort through analogue current control (minimum value 1%); light source replaceable by an authorized professional;



### General

Ceiling / Wall , Track

brushed aluminium

IP20

764 lm

### LED

2700 K

CRI  $\geq 90$

L80 / 50000 h

initial MacAdam  $\leq 2$  SDCM

R<sub>g</sub>: 99 , R<sub>f</sub>: 91 , R<sub>{1-15}</sub>: 89

MR 0.53

MDER 0.48

### Optical

Medium

beam angle 24°

### Electrical

DALI-2

9.6 W

PC3

80 lm/W

1 DALI Addr.

### Physical

diameter 32 mm

height 60 mm

### Light distribution



medium 24°

h (m)	E0° (lx)	ø (m)
1	4060	0.42
2	1020	0.83
3	450	1.25
4	250	1.67
5	160	2.09

### Product drawing

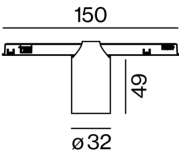

### Installation instructions

