

**Quickinfo**

2700 K, 3000 K, 3500 K, 4000 K  
 CRI ≥ 90 / 2 SDCM (initial MacAdam)  
 UGR ≤ 10, UGR ≤ 13, UGR ≤ 16, UGR ≤ 19  
 bis zu 95 lm/W  
 L80 / 50000 h  
 DALI-2, nicht dimmbar  
 IP20

**Types**

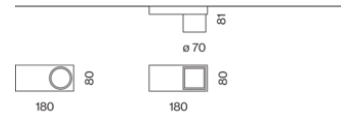

**Farbe**



**Innenfarbe**



**Lichtverteilung**



**SASSO 60 base 1 lamp**

ceiling

**EN** Cylindrical or square spotlight made of aluminium; light inset lacquered; housing powder coated; light inset rotatable and tiltable (cylindrical versions); surface mounted housing in aluminium incl. converter; mounting plate with pre-assembled converter unit can be pre-mounted; luminaire housing can be attached without tools by interlock; precise radiation characteristic due to high quality lens system; COB (Chip on Board) technology for maximum efficiency; no multiple shadows; efficient LEDs with very good colour rendering; luminaire for through wiring

**DE** Zylindrischer bzw. quadratischer Strahler aus Aluminium; Lichteinsatz lackiert; Gehäuse pulverbeschichtet; Lichteinsatz dreh- und schwenkbar (zylindr. Varianten); Anbauehäuse aus Aluminium inkl. Converter; Montageplatte mit vormontierter Konvertereinheit vorab montierbar; Leuchtenkörper mittels Verriegelung werkzeuglos aufsetzbar; präzise Abstrahlcharakteristik durch hochwertige Linsenoptik; COB (Chip on Board) Technologie für höchste Effizienz; keine Mehrfachschatten; effiziente LEDs mit sehr guter Farbwiedergabe; Leuchte für Weiterverdrahtung



glare control  
(UGR ≤ 16)



easy mounting  
no visible  
screws



CRI ≥ 95 2  
SDCM  
(optional)



## SASSO 60 base round adjustable 1 lamp ceiling



### SPOT 15°, CRI ≥ 90

SYSTEM	COLOUR TEMP.	LUM. FLUX	EFFICACY	ORDER CODE
10.4 W	2700 K	735 lm	71 lm/W	0 4 8 - 3 1 3 0 9 ⇄ ■ ■ S
	3000 K	759 lm	73 lm/W	0 4 8 - 3 1 3 0 0 ⇄ ■ ■ S
	3500 K	775 lm	75 lm/W	0 4 8 - 3 1 3 0 2 ⇄ ■ ■ S
	4000 K	799 lm	77 lm/W	0 4 8 - 3 1 3 0 1 ⇄ ■ ■ S

The data values for the luminous flux may differ for specific order options by -8%. Luminous flux value refers to inner colour traffic white.

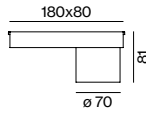

### MEDIUM 27°, CRI ≥ 90

SYSTEM	COLOUR TEMP.	LUM. FLUX	EFFICACY	ORDER CODE
10.2 W	2700 K	874 lm	86 lm/W	0 4 8 - 3 1 3 0 9 ⇄ ■ ■ M
	3000 K	907 lm	89 lm/W	0 4 8 - 3 1 3 0 0 ⇄ ■ ■ M
	3500 K	927 lm	91 lm/W	0 4 8 - 3 1 3 0 2 ⇄ ■ ■ M
	4000 K	946 lm	93 lm/W	0 4 8 - 3 1 3 0 1 ⇄ ■ ■ M

The data values for the luminous flux may differ for specific order options by -9%. Luminous flux value refers to inner colour traffic white.

### FLOOD 40°-41°, CRI ≥ 90

SYSTEM	COLOUR TEMP.	LUM. FLUX	EFFICACY	ORDER CODE
10.2 W	2700 K	831 lm	81 lm/W	0 4 8 - 3 1 3 0 9 ⇄ ■ ■ F
	3000 K	862 lm	85 lm/W	0 4 8 - 3 1 3 0 0 ⇄ ■ ■ F
	3500 K	880 lm	86 lm/W	0 4 8 - 3 1 3 0 2 ⇄ ■ ■ F
	4000 K	899 lm	88 lm/W	0 4 8 - 3 1 3 0 1 ⇄ ■ ■ F

The data values for the luminous flux may differ for specific order options by -14%. Luminous flux value refers to inner colour traffic white.

### WIDE FLOOD 56°, CRI ≥ 90

SYSTEM	COLOUR TEMP.	LUM. FLUX	EFFICACY	ORDER CODE
10.2 W	2700 K	876 lm	86 lm/W	0 4 8 - 3 1 3 0 9 ⇄ ■ ■ W
	3000 K	909 lm	89 lm/W	0 4 8 - 3 1 3 0 0 ⇄ ■ ■ W
	3500 K	928 lm	91 lm/W	0 4 8 - 3 1 3 0 2 ⇄ ■ ■ W
	4000 K	948 lm	93 lm/W	0 4 8 - 3 1 3 0 1 ⇄ ■ ■ W

The data values for the luminous flux may differ for specific order options by -11%. Luminous flux value refers to inner colour traffic white.



## SASSO 60 base square downlight 1 lamp ceiling

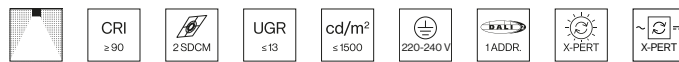

### SPOT 15°, CRI ≥ 90

SYSTEM	COLOUR TEMP.	LUM. FLUX	EFFICACY	ORDER CODE
10.4 W	2700 K	751 lm	72 lm/W	0 4 8 - 3 0 3 0 9 ⇄ ■ ■ S
	3000 K	775 lm	75 lm/W	0 4 8 - 3 0 3 0 0 ⇄ ■ ■ S
	3500 K	792 lm	76 lm/W	0 4 8 - 3 0 3 0 2 ⇄ ■ ■ S
	4000 K	816 lm	78 lm/W	0 4 8 - 3 0 3 0 1 ⇄ ■ ■ S

The data values for the luminous flux may differ for specific order options by -7%. Luminous flux value refers to inner colour matt silver.

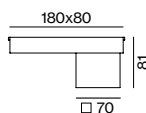

### Order options

CONTROL		⇄ COLOUR		■ INNER COLOUR	
non DIM	1	jet black RAL 9005	1	jet black RAL 9005	1
DALI-2	3	traffic white RAL 9016	7	matt silver	4
				traffic white RAL 9016	7
				gold dust RAL 260-M	9

**MEDIUM 27°, CRI ≥ 90**

SYSTEM	COLOUR TEMP.	LUM. FLUX	EFFICACY	ORDER CODE
10.2 W	2700 K	894 lm	88 lm/W	0 4 8 - 3 0 3 0 9 <input checked="" type="checkbox"/> <input checked="" type="checkbox"/> M
	3000 K	928 lm	91 lm/W	0 4 8 - 3 0 3 0 0 <input checked="" type="checkbox"/> <input checked="" type="checkbox"/> M
	3500 K	948 lm	93 lm/W	0 4 8 - 3 0 3 0 2 <input checked="" type="checkbox"/> <input checked="" type="checkbox"/> M
	4000 K	968 lm	95 lm/W	0 4 8 - 3 0 3 0 1 <input checked="" type="checkbox"/> <input checked="" type="checkbox"/> M

The data values for the luminous flux may differ for specific order options by -9%. Luminous flux value refers to inner colour matt silver.

**FLOOD 40°-42°, CRI ≥ 90**

SYSTEM	COLOUR TEMP.	LUM. FLUX	EFFICACY	ORDER CODE
10.2 W	2700 K	856 lm	84 lm/W	0 4 8 - 3 0 3 0 9 <input checked="" type="checkbox"/> <input checked="" type="checkbox"/> F
	3000 K	888 lm	87 lm/W	0 4 8 - 3 0 3 0 0 <input checked="" type="checkbox"/> <input checked="" type="checkbox"/> F
	3500 K	907 lm	89 lm/W	0 4 8 - 3 0 3 0 2 <input checked="" type="checkbox"/> <input checked="" type="checkbox"/> F
	4000 K	926 lm	91 lm/W	0 4 8 - 3 0 3 0 1 <input checked="" type="checkbox"/> <input checked="" type="checkbox"/> F

The data values for the luminous flux may differ for specific order options by -13%. Luminous flux value refers to inner colour matt silver.

**WIDE FLOOD 57°-58°, CRI ≥ 90**

SYSTEM	COLOUR TEMP.	LUM. FLUX	EFFICACY	ORDER CODE
10.2 W	2700 K	895 lm	88 lm/W	0 4 8 - 3 0 3 0 9 <input checked="" type="checkbox"/> <input checked="" type="checkbox"/> W
	3000 K	928 lm	91 lm/W	0 4 8 - 3 0 3 0 0 <input checked="" type="checkbox"/> <input checked="" type="checkbox"/> W
	3500 K	949 lm	93 lm/W	0 4 8 - 3 0 3 0 2 <input checked="" type="checkbox"/> <input checked="" type="checkbox"/> W
	4000 K	969 lm	95 lm/W	0 4 8 - 3 0 3 0 1 <input checked="" type="checkbox"/> <input checked="" type="checkbox"/> W

The data values for the luminous flux may differ for specific order options by -10%. Luminous flux value refers to inner colour matt silver.

**Order options**

CONTROL		COLOUR		INNER COLOUR	
non DIM	1	jet black RAL 9005	1	jet black RAL 9005	1
DALI-2	3	traffic white RAL 9016	7	matt silver	4
				traffic white RAL 9016	7
				gold dust RAL 260-M	9

# Oppenländer Rechtsanwälte, Stuttgart

Deutschland

## Architekt

Ippolito Fleitz Group  
GmbH

## Fotograf

Zoey Braun

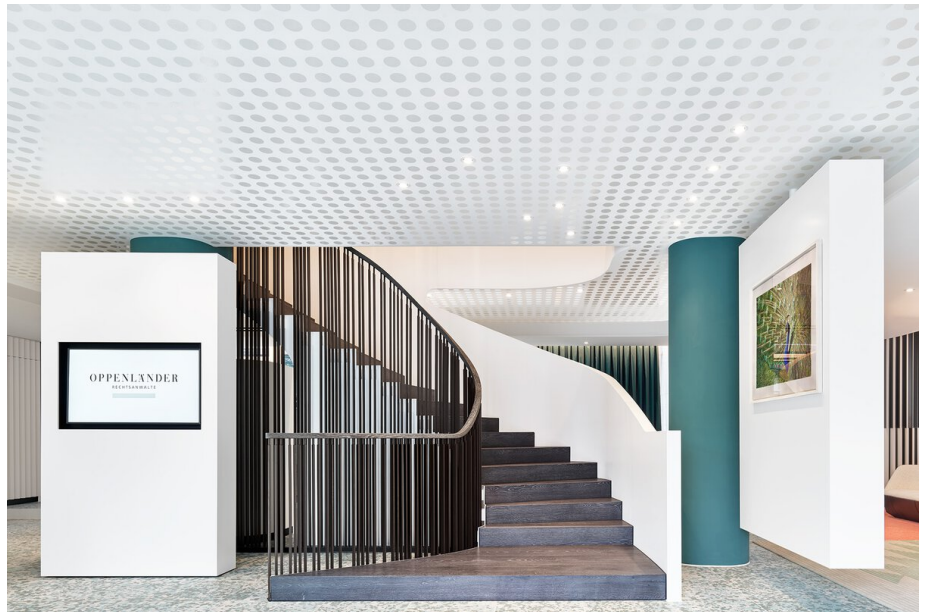

## Verwendete Produkte



**SASSO 100 round ceiling**



**MINO 60 CIRCLE suspended**



**SASSO 60 base 1 lamp ceiling**

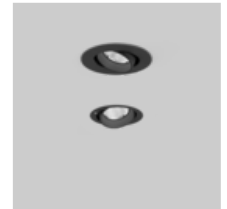

**SASSO PRO 80 adjustable flush round recessed**

