

MOVE IN 1.0

round

recessed

Project/Type

Date



TOOLESS MODULE INSTALLATION

MAX GLARE REDUCTION

360° ROTATION AND 90° TILT

1" APERTURE

General	ceiling recessed, semi-recessed optic aperture: 1" ceiling aperture: 2 1/8" tilt max 90° rotation 360° dry, damp rated up to 726 lm delivered
LED	COB, L80 / 50 000h CRI ≥ 90, SDCM ≤ 2-step binning 2700 K, 3000 K, 3500 K, 4000 K
Optical	spot (18°), medium (24°), flood (34°)
Electrical	fixture: 6.8 W up to 80 lm/W 0-10V (0.1%, 120-277 V), Triac (1%, 120 V)
Physical	traffic white, jet black, chrome, brushed aluminum light module: aluminum housing: galvanized steel

Dimensions

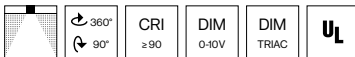
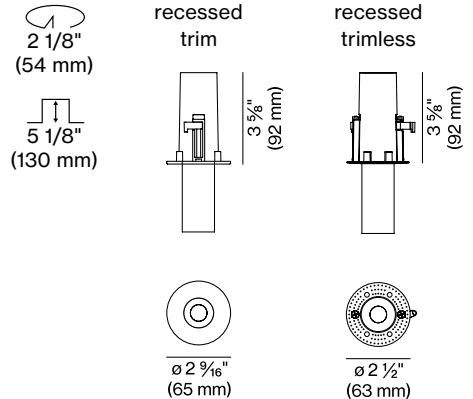

Round spotlight element in aluminium; powder coated; installation without tools in mounting set (trimless or with trim) with patented ball catch system; special mounting tool for easy installation of the trimless housing available as an accessory (on request); spotlight element height adjustable without tools: flush with the ceiling, or extended 1" or 1 3/8"; spotlight head rotates 360° and tilts 90°; COB (Chip on Board) technology for maximum efficiency; no multiple shadows; energy-efficient LEDs with excellent color rendering; high-quality, aluminium, vapour deposition coated reflector with faceted design; precise radiation characteristic; good glare reduction due to recessed light point plane; optical attachments as accessories on request

MOVE IN 1.0

round

recessed

Project/Type

Date

Order Code

Range	Shape	Mounting	LED	Driver	Power	Application	Type	Optic Beam	Optic Type	Finish Inset	Finish Trim
UMN10 MOVE IN 1.0	R round	TT trim/trimless	279 2700K CRI 90	UV 0-10V 0.1% 120-277V	S standard power 6.8W	R remodel non-IC	A adjustable	S spot 18°	C reflector chrome	W traffic white	W traffic white
			309 3000K CRI 90							B jet black	B jet black
			359 3500K CRI 90							A brushed aluminum	
			409 4000K CRI 90							C chrome	
				1U 0-10V Triac 1% 120V		N new construction non-IC	F fix	M medium 24°			
						I new construction IC		F flood 34°			
						C new construction CCEA					

Finish Inset



traffic white



jet black



brushed alu.



chrome

Finish Trim



traffic white

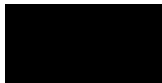

jet black

MOVE IN 1.0

round

recessed

Project/Type

Date

Photometric Data

S – spot (18°)

Power W	CCT K	Output lm	Efficacy lm/W
6.8 standard power	2700K	644	71
	3000K	668	74
	3500K	682	75
	4000K	697	77

M – medium (24°)

Power W	CCT K	Output lm	Efficacy lm/W
6.8 standard power	2700K	671	74
	3000K	696	77
	3500K	711	79
	4000K	726	80

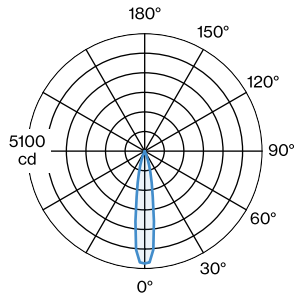

spot 18°

h (ft)	E0° (fc)	ø (ft)
2	1220	0.63
4	300	1.27
6	140	1.90
8	80	2.54
10	50	3.17

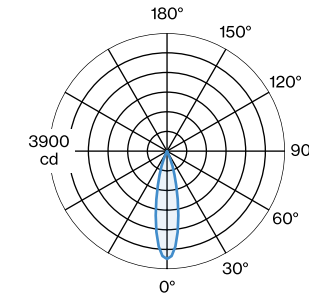

medium 24°

h (ft)	E0° (fc)	ø (ft)
2	891	0.83
4	223	1.67
6	99	2.50
8	56	3.34
10	36	4.17

F – flood (34°)

Power W	CCT K	Output lm	Efficacy lm/W
6.8 standard power	2700K	640	71
	3000K	664	73
	3500K	678	75
	4000K	693	77

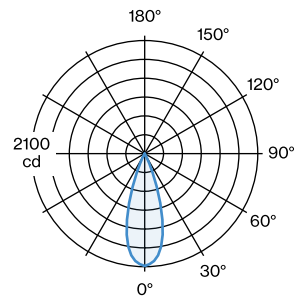

flood 34°

h (ft)	E0° (fc)	ø (ft)
2	522	1.21
4	130	2.42
6	58	3.63
8	33	4.85
10	21	6.06

MOVE IN 1.0

round

recessed

Project / Type

Date

Remodel non-IC Installation

Housing for new or existing ceiling structure. Suitable for non-insulated ceilings (sheetrock, or paneling). Fixture is ready for remodeling installation. Mounting set can be shipped separately.

Ceiling thickness
up to 1" (25.4 mm)

Cutout dimensions

recessed trim $2 \frac{1}{8}"$ (54 mm) $5 \frac{1}{8}"$ (130 mm)

recessed trimless $2 \frac{1}{8}"$ (54 mm) $5 \frac{1}{8}"$ (130 mm)

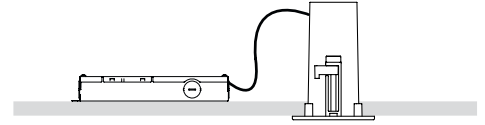

For power supply installation keep clearance of 1 ft. (300 mm) behind the ceiling

New Construction IC / CCEA Installation

Housing with hanger bar system for new construction installations. Available as IC-rated housing or Chicago Plenum (CCEA) housing. Suitable for insulated ceilings (IC) or Chicago Plenum applications (CCEA). Housing can be shipped separately.

Ceiling thickness
up to 1" (25.4 mm)

Hanger bars adjustment
16" to 24" (406 to 610 mm)

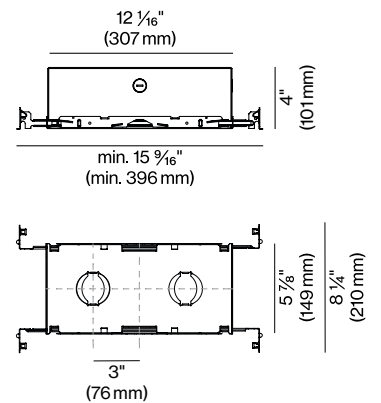
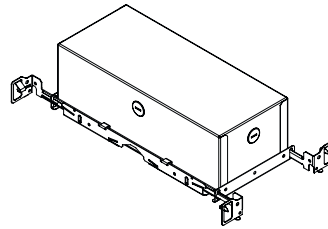

New Construction non-IC Installation

Housing with hanger bars system for new construction installations. Suitable only for non-insulated ceilings. Mounting frame can be shipped separately.

Ceiling thickness
up to 1" (25.4 mm)

Hanger bars adjustment
16" to 24" (406 to 610 mm)

