



## FRAME 60

recessed with trim

**EN** Luminaire housing made of extruded aluminium; recessed luminaire with trim; suitable for ceiling thickness of 8-25 mm; surface powder coated; luminaire profile for mounting available in advance; remaining luminaire components mounted without tools; light inset consisting of highly reflective coated extruded profile for improved thermal management; HPO (High Performance Opal) cover for uniform illumination; micro prismatic PMMA diffuser incl. diffuser film for homogeneous illumination and reduced luminance; energy-efficient LEDs with very good colour rendering

**FR** Corps de luminaire en profil extrudé en aluminium ; luminaire encastré avec bord continu ; convient aux épaisseurs de plafond de 8-25mm ; surface thermolaquée ; Profilé de luminaire pour montage livrable avant ; composants restants du luminaire montable sans outil ; élément lumineux composé de profilé extrudé laqué hautement réfléchissant pour une gestion thermique améliorée ; cache HPO (High Performance Opal) pour éclairage homogène ; cache PMMA microprismatique, avec film diffusant inclus pour réduire la brillance avec un éclairage homogène ; LED économes en énergie à restitution de couleur élevée

### Quickinfo

3000 K, 4000 K, TW  
 CRI ≥ 80, CRI ≥ 90, 3 SDCM  
 up to 125 lm/W  
 L90 @ 50 000 h  
 non DIM, DALI-2  
 opal, microprismatic (UGR ≤ 19)

### Types



### Colours



### Light distributions

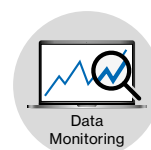

DiiA® standards  
 251, 252, 253



system  
 solution (p. 892)

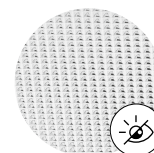

microprismatic  
 UGR ≤ 19

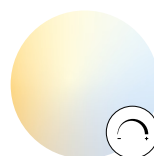

tunable white  
 2700–6500 K

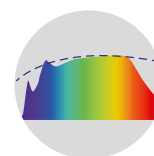

CRI ≥ 98  
 XPECTRUM

## Order options

### COLOUR TEMPERATURE

3000 K (CRI $\geq$ 90)	0
4000 K (CRI $\geq$ 90)	1
3000 K (CRI $\geq$ 80)	5
4000 K (CRI $\geq$ 80)	6
tunable white 2700–6500 K*	

\*DALI-2 DT8

### CONTROL

non DIM	1
DALI-2	3

### MATERIAL COLOUR

<input type="radio"/> traffic white RAL 9016	7
<input checked="" type="radio"/> white aluminium RAL 9006	G

### LIGHT OPTIC COVER

opal high performance	H
microprismatic	Z
microprismatic (UGR $\leq$ 19)*	G

\*UGR $\leq$ 19 only with mid lumen

## Options on request

### COLOUR RENDERING INDEX

CRI $\geq$ 98 XPECTRUM

### INDIVIDUAL MATERIAL COLOUR

please contact factory

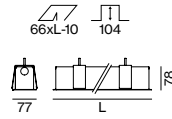
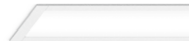

## FRAME 60 trim



### MID LUMEN

SYS. POWER	COLOUR TEMP.	LUM. FLUX	L (mm)	ORDER CODE
8.7 W	3000 K	902 lm	593	0 5 2 - 4 7 L 2 :: 1 <input type="checkbox"/> <input type="checkbox"/>
	4000 K	955 lm		
13 W	3000 K	1350 lm	893	0 5 2 - 4 7 L 3 :: 1 <input type="checkbox"/> <input type="checkbox"/>
	4000 K	1430 lm		
15.3 W	3000 K	1800 lm	1193	0 5 2 - 4 7 L 4 :: 1 <input type="checkbox"/> <input type="checkbox"/>
	4000 K	1910 lm		
19.2 W	3000 K	2250 lm	1493	0 5 2 - 4 7 L 5 :: 1 <input type="checkbox"/> <input type="checkbox"/>
	4000 K	2390 lm		
31 W	3000 K	3610 lm	2365	0 5 2 - 4 7 L 8 :: 1 <input type="checkbox"/> <input type="checkbox"/>
	4000 K	3820 lm		

### HIGH LUMEN

SYS. POWER	COLOUR TEMP.	LUM. FLUX	L (mm)	ORDER CODE
13.8 W	3000 K	1490 lm	593	0 5 2 - 4 7 M 2 :: <input type="checkbox"/> <input type="checkbox"/> <input type="checkbox"/>
	4000 K	1580 lm		
20.6 W	3000 K	2240 lm	893	0 5 2 - 4 7 M 3 :: <input type="checkbox"/> <input type="checkbox"/> <input type="checkbox"/>
	4000 K	2370 lm		
27.5 W	3000 K	2980 lm	1193	0 5 2 - 4 7 M 4 :: <input type="checkbox"/> <input type="checkbox"/> <input type="checkbox"/>
	4000 K	3160 lm		
34 W	3000 K	3730 lm	1493	0 5 2 - 4 7 M 5 :: <input type="checkbox"/> <input type="checkbox"/> <input type="checkbox"/>
	4000 K	3950 lm		
55 W	3000 K	5970 lm	2365	0 5 2 - 4 7 M 8 :: <input type="checkbox"/> <input type="checkbox"/> <input type="checkbox"/>
	4000 K	6320 lm		

### TUNABLE WHITE

SYS. POWER	COLOUR TEMP.	LUM. FLUX	L (mm)	ORDER CODE
21.7 W	2700–6500 K	2230 lm	880	0 5 2 - 4 7 3 3 D 3 <input type="checkbox"/> <input type="checkbox"/>
29 W	2700–6500 K	2980 lm	1180	0 5 2 - 4 7 3 4 D 3 <input type="checkbox"/> <input type="checkbox"/>
36 W	2700–6500 K	3720 lm	1480	0 5 2 - 4 7 3 5 D 3 <input type="checkbox"/> <input type="checkbox"/>
58 W	2700–6500 K	5960 lm	2352	0 5 2 - 4 7 3 8 D 3 <input type="checkbox"/> <input type="checkbox"/>

## Mounting accessories

### CONCRETE INSTALLATION HOUSING

L (mm)	W-H (mm)	ORDER CODE
635	75-88	0 3 5 - 0 4 0 6 6
935	75-88	0 3 5 - 0 4 0 9 6
1235	75-88	0 3 5 - 0 4 1 2 6
1535	75-88	0 3 5 - 0 4 1 5 6
2407	75-88	0 3 5 - 0 4 2 3 6

no use for wall installation (only on request)

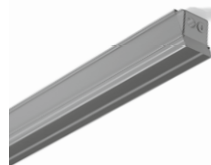

**LUMINOUS FLUX** value calculated for  
CRI $\geq$ 80, colour white, cover opal  
microprismatic -13%