



FRAME 60

recessed with trim

^{EN} Luminaire housing made of extruded aluminium; recessed luminaire with trim; suitable for ceiling thickness of 8-25 mm; surface powder coated; luminaire profile for mounting available in advance; remaining luminaire components mounted without tools; light inset consisting of highly reflective coated extruded profile for improved thermal management; HPO (High Performance Opal) cover for uniform illumination; micro prismatic PMMA diffuser incl. diffuser film for homogeneous illumination and reduced luminance; energy-efficient LEDs with very good colour rendering

^{DE} Leuchtenkörper aus Aluminiumstrangpressprofil; Einbauleuchte mit umlaufendem Rand; geeignet für Deckenstärken von 8-25 mm; Oberfläche pulverbeschichtet; Leuchtenprofil für Montage vorab lieferbar; restliche Leuchtenkomponenten werkzeuglos montierbar; Lichteinsatz bestehend aus hochreflektierend lackiertem Strangpressprofil für verbessertes Thermomanagement; HPO (High Performance Opal) Abdeckung für homogene Ausleuchtung; mikroprismatische PMMA-Abdeckung inkl. Diffusorfolie zur Reduktion der Leuchtdichte bei homogener Ausleuchtung; energieeffiziente LEDs mit sehr guter Farbwiedergabe

Quickinfo

3000 K, 4000 K, TW
 CRI ≥ 80, CRI ≥ 90, 3 SDCM
 up to 125 lm/W
 L90 @ 50 000 h
 non DIM, DALI-2
 opal, microprismatic (UGR ≤ 19)

Types



Colours



Light distributions

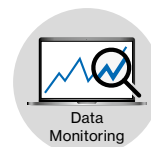

DiiA® standards
 251, 252, 253



system
 solution (p. 892)

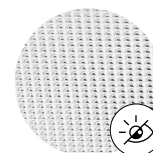

microprismatic
 UGR ≤ 19

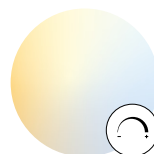

tunable white
 2700–6500 K

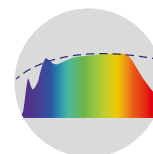

CRI ≥ 98
 XPECTRUM

Order options

COLOUR TEMPERATURE

3000 K (CRI \geq 90)	0
4000 K (CRI \geq 90)	1
3000 K (CRI \geq 80)	5
4000 K (CRI \geq 80)	6
tunable white 2700–6500 K*	

*DALI-2 DT8

CONTROL

non DIM	1
DALI-2	3

MATERIAL COLOUR

<input type="radio"/> traffic white RAL 9016	7
<input checked="" type="radio"/> white aluminium RAL 9006	G

LIGHT OPTIC COVER

opal high performance	H
microprismatic	Z
microprismatic (UGR \leq 19)*	G

*UGR \leq 19 only with mid lumen

Options on request

COLOUR RENDERING INDEX

CRI \geq 98 XPECTRUM

INDIVIDUAL MATERIAL COLOUR

please contact factory

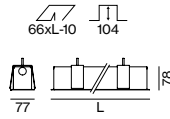

FRAME 60 trim



MID LUMEN

SYS. POWER	COLOUR TEMP.	LUM. FLUX	L (mm)	ORDER CODE
8.7 W	3000 K	902 lm	593	0 5 2 - 4 7 L 2 :: 1 <input checked="" type="checkbox"/> <input checked="" type="checkbox"/>
	4000 K	955 lm		
13 W	3000 K	1350 lm	893	0 5 2 - 4 7 L 3 :: 1 <input checked="" type="checkbox"/> <input checked="" type="checkbox"/>
	4000 K	1430 lm		
15.3 W	3000 K	1800 lm	1193	0 5 2 - 4 7 L 4 :: 1 <input checked="" type="checkbox"/> <input checked="" type="checkbox"/>
	4000 K	1910 lm		
19.2 W	3000 K	2250 lm	1493	0 5 2 - 4 7 L 5 :: 1 <input checked="" type="checkbox"/> <input checked="" type="checkbox"/>
	4000 K	2390 lm		
31 W	3000 K	3610 lm	2365	0 5 2 - 4 7 L 8 :: 1 <input checked="" type="checkbox"/> <input checked="" type="checkbox"/>
	4000 K	3820 lm		

HIGH LUMEN

SYS. POWER	COLOUR TEMP.	LUM. FLUX	L (mm)	ORDER CODE
13.8 W	3000 K	1490 lm	593	0 5 2 - 4 7 M 2 :: <input checked="" type="checkbox"/> <input checked="" type="checkbox"/> <input checked="" type="checkbox"/>
	4000 K	1580 lm		
20.6 W	3000 K	2240 lm	893	0 5 2 - 4 7 M 3 :: <input checked="" type="checkbox"/> <input checked="" type="checkbox"/> <input checked="" type="checkbox"/>
	4000 K	2370 lm		
27.5 W	3000 K	2980 lm	1193	0 5 2 - 4 7 M 4 :: <input checked="" type="checkbox"/> <input checked="" type="checkbox"/> <input checked="" type="checkbox"/>
	4000 K	3160 lm		
34 W	3000 K	3730 lm	1493	0 5 2 - 4 7 M 5 :: <input checked="" type="checkbox"/> <input checked="" type="checkbox"/> <input checked="" type="checkbox"/>
	4000 K	3950 lm		
55 W	3000 K	5970 lm	2365	0 5 2 - 4 7 M 8 :: <input checked="" type="checkbox"/> <input checked="" type="checkbox"/> <input checked="" type="checkbox"/>
	4000 K	6320 lm		

TUNABLE WHITE

SYS. POWER	COLOUR TEMP.	LUM. FLUX	L (mm)	ORDER CODE
21.7 W	2700–6500 K	2230 lm	880	0 5 2 - 4 7 3 3 D 3 <input checked="" type="checkbox"/> <input checked="" type="checkbox"/>
29 W	2700–6500 K	2980 lm	1180	0 5 2 - 4 7 3 4 D 3 <input checked="" type="checkbox"/> <input checked="" type="checkbox"/>
36 W	2700–6500 K	3720 lm	1480	0 5 2 - 4 7 3 5 D 3 <input checked="" type="checkbox"/> <input checked="" type="checkbox"/>
58 W	2700–6500 K	5960 lm	2352	0 5 2 - 4 7 3 8 D 3 <input checked="" type="checkbox"/> <input checked="" type="checkbox"/>

Mounting accessories

CONCRETE INSTALLATION HOUSING

L (mm)	W-H (mm)	ORDER CODE
635	75-88	0 3 5 - 0 4 0 6 6
935	75-88	0 3 5 - 0 4 0 9 6
1235	75-88	0 3 5 - 0 4 1 2 6
1535	75-88	0 3 5 - 0 4 1 5 6
2407	75-88	0 3 5 - 0 4 2 3 6

no use for wall installation (only on request)

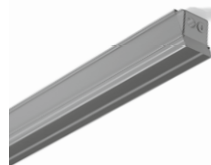

LUMINOUS FLUX value calculated for
CRI \geq 80, colour white, cover opal
microprismatic -13%